

FOLDING BRACKET
User's Manual[Model SZ-17Q]
for $\phi 17.3$ Pole Size[Model SZ-22Q]
for $\phi 21.7$ Pole Size

Thank you for purchasing the PATLITE Folding Bracket for your application. Prior to installation, please read through this manual for proper installation and precautionary steps. In addition, please store this manual for future reference when performing maintenance, repairs or inspections. If you have any questions regarding this product, please contact our PATLITE Sales Representative.

Safety Precautions

In order to prevent any damage to the user and other personnel or to assets, note the following:

◆ The following symbols classifies the following precautions into two categories and explains the level of harm inflicted when caution is disregarded while using this product.

- Warning** Displays the warning "Failure to follow warning may lead to death or severe injury".
- Caution** Displays the warning "Failure to follow caution may lead from light to medium injury or may lead to property loss or injury to others".

◆ The following symbols indicate and explains the nature of the information to be observed.

- Prohibited** This symbol indicates "Prohibited", which should not be carried out by all means.
- Enforced** This symbol indicates "Enforced", which should be observed and carried out by all means.

1. For safe application, observe the following

Warning

- Do not disassemble or modify this product.
- After installing this product to the machine, etc., do not operate it with the cover removed or use it as a step-ladder when climbing onto the machinery. Failure to comply may result in falling off the machinery or product damage may occur.

Enforced

- Be sure to disconnect the power of the product before wiring, mounting, exchanging, relocating or repairing the product.
- Request the installation and wiring to be accompanied by a professional contractor. Failure to comply may result in electric shock, fire, or falling from high places.
- Verify the installation location is sturdy enough to handle the weight of the product and has no vibrations exceeding the specified limitations. If installed in a place where it exceeds specifications, product damage may occur.

2. Part Names and Dimensions

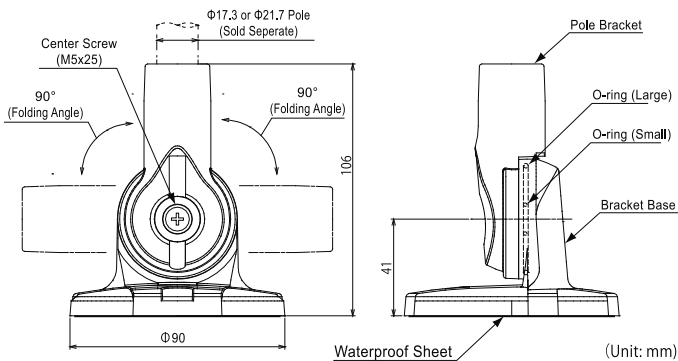

3. Bracket Assembly

Caution

- Make sure the O-ring on the pole is not deformed when inserting the pole. Failure to comply may result in waterproof construction deterioration or loss.
- Make sure lead wires do not get caught between the pole and bracket when inserting the pole.
- Make sure the power is disconnected to avoid shock or short-circuiting from the lead wires.

- Remove the center screw affixing the bracket and separate the Pole Bracket from the Bracket Base.
- Thread the lead wires through the Pole Bracket section.
- Slide the pole all the way into the Pole Bracket until the pole hits the bottom.
- Use the positioning screws to secure the pole into place. (Recommended Torque: 0.68N·m)
- Thread the lead wires through the Pole Bracket and join it with the Bracket Base.
- Insert the center screw and tighten it to fix the bracket position. (Recommended Torque: 2.4N·m)

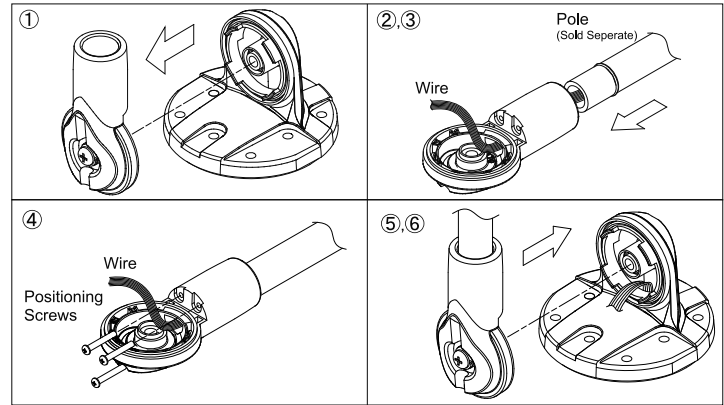

4. Installation

■ Mounting

- Make four mounting holes in the places indicated in the Installation Diagram. Please select from two types of P.C.D.
- Tighten with the proper nuts and bolts. (Recommended Torque: 1.2 N·m)

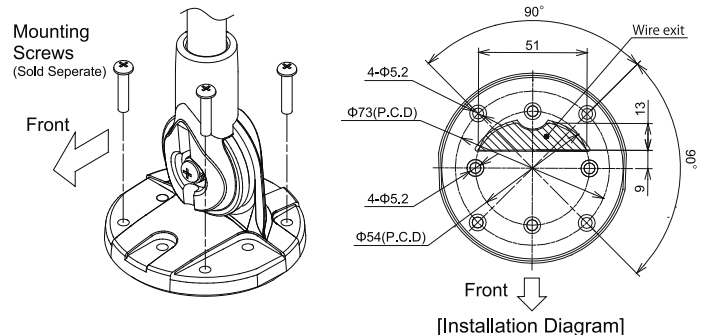

5. Folding Instructions

When a Signal Tower is installed onto portable equipment, perform the following steps prior to transporting the equipment.

- Loosen the center screw far enough for the tabs to clear from the inserts so the bracket can be easily folded down.
※ Do not attempt to fold the bracket with the tabs still inserted in the inserts, or damage to the bracket will occur when folding.

- Loosely tighten the center screw to secure the Signal Tower prior to transporting.

- After relocation, repeat steps ① and ② in reverse order to install the bracket back to its original position. (Recommended Torque: 2.4N·m)
※ Align the four tabs with the inserts.
※ Do not remove any O-rings.

6. Specifications

Model	SZ-17Q+00103	SZ-22Q+00103
Mounting Location	Indoors	
Operating Ambient Temperature and Ambient Humidity	Conform to the specifications of the Signal tower	
Mass	100g	105g
Compatible Brackets (Sold Separate)	SZ-60-□AL+00102 SZ-80-□AL+00102	LME-□02(FB) LMS-□02

Note

- Specifications and dimensions may change without prior notice for improvements, etc.

PATLITE Corporation

G1E

International Division Sales & Marketing Department
 Inaba Building 4-11-14 Itachibori Nishi-ku Osaka 550-0012 Japan
PATLITE (U.S.A.) Corporation
 20130 S. Western Avenue, Torrance, CA 90501 U.S.A.
PATLITE Europe GmbH
 Am Soeldnermoos 8, D-85399 Hallbergmoos, Germany
PATLITE (SINGAPORE) PTE LTD
 No.2 Leng Kee Road, #05-01 Thye Hong Centre, Singapore 159086
PATLITE (CHINA) Corporation
 Room 512, Jufeng Business Building, No.697-3 Lingshi Road, Shanghai 200072, China
PATLITE KOREA CO., LTD.
 A-2603, Daesung D-POLIS, 543-1 Gasan-dong, Geumcheon-gu, Seoul, 153-719 Korea
PATLITE Japan Representative Office in Taiwan
 7F, No. 91, Huayin St, Datong District Taipei, Taiwan R.O.C

TEL. +81-6-7688-5400
 FAX. +81-6-7688-5401
 TEL. +1-310-328-3222
 FAX. +1-310-328-2676
 TEL. +49-811-99819770-0
 FAX. +49-811-99819770-9
 TEL. +65-6226-1111
 FAX. +65-6324-1411
 TEL. +86-21-6630-8969
 FAX. +86-21-6630-8938
 TEL. +82-2-523-6636
 FAX. +82-2-861-9919
 TEL. +886-2-2555-1611
 FAX. +886-2-2555-1621

<http://www.patlite.com/>

PATLITE and the PATLITE logo is a trademark, or registered trademark of the PATLITE Corporation of Japan and each country.