

# LU7 Loud Buzzer Unit Instruction Manual [TYPE : LU7-LB]

C95100137 D

生産終了  
Production end

Thank you for purchasing Patlite's LU7 Loud Buzzer Unit [LU7-LB]. Prior to installation, read this manual thoroughly before using this product to ensure correct use. Store this book in a safe place, and when performing maintenance and repairs, etc., please be sure to reread this book. In addition, if there are any questions concerning this product, feel free to contact your PATLITE Sales Representative.

## 1 For safe application, observe the following:

### Safety Precautions

In order to prevent any damage to the user and other personnel or to assets, note the following:

◆The warning indications are divided into the following classes according to the degree of danger or damage incurred when the warning is not taken into consideration and the product is not correctly used.

**Warning** Displays the warning "Failure to follow warning may lead to death or severe injury".

**Caution** Displays the warning "Failure to follow caution may lead from light to medium injury or maylead to property loss or injury to others".

### Warning

- Prior to installation and wiring, ensure the power is disconnected and the Main Unit is turned off.  
Failure to comply may result in damage of the internal circuitry and the danger of electric shock due to short-circuiting.
- Request the installation and wiring be performed by a professional contractor if construction work is involved. Failure to comply may result in electric shock, fire, or falling from high places.
- If this product is used for security purposes, use it in addition to other security products and inspect it periodically.

### Caution

- Do not touch parts or the PCB pattern, other than the socket slide switch when wiring, assembling, and removal.  
The parts on the board may be damaged by static electricity.
- Avoid long exposure to the buzzer sound from a close distance. Failure to observe this may lead from irritation to permanent damage to the ears.
- Be sure to install this product (buzzer unit on top) in the upright position. <If attached in other means for Uprights, there is a possibility that the unit may separate.
- Do not operate with the head cover or LED unit removed. Possible cause of failure may occur.

### Note

- This buzzer unit is designed specifically for LU7 Signal Tower Series LU7-02 (FB), LU7-M2 (FB), and LU7-02S.
- This unit cannot be used as a single unit.
- Install this unit on the top of the signal tower. It can only be installed for the highest tier.
- The head cover should be used to attach onto the buzzer unit.

## 2 Model Number Configuration

LU7 - **LB** ← LB: Loud Buzzer Unit

## 3 Part Names and Outer Appearance

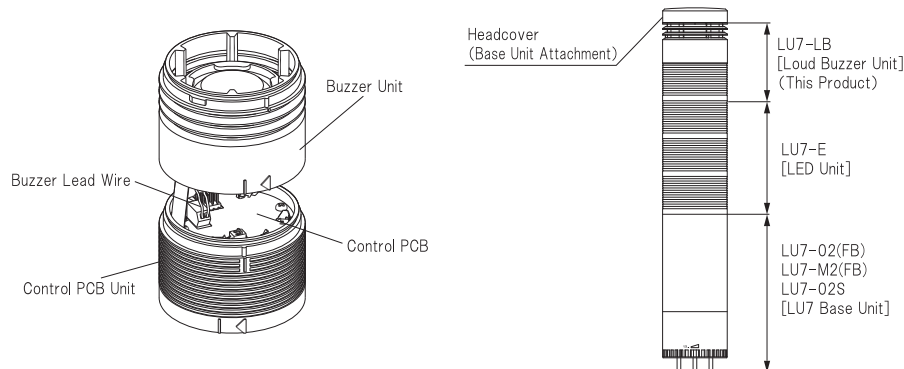

## 4 Installation

### Warning

- Be sure the power is disconnected before working on the product. Failure to comply may result in damage of the internal circuitry and the danger of electric shock due to short-circuiting.

[Procedure 1]

Remove the LU7 Main Unit Headcover.

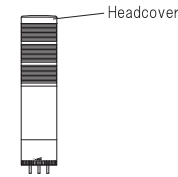

[Procedure 2]

The buzzer unit can be removed from the control base unit.

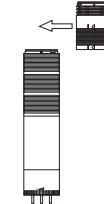

[Procedure 3]

The head cover removed in [Procedure 1] is used again.

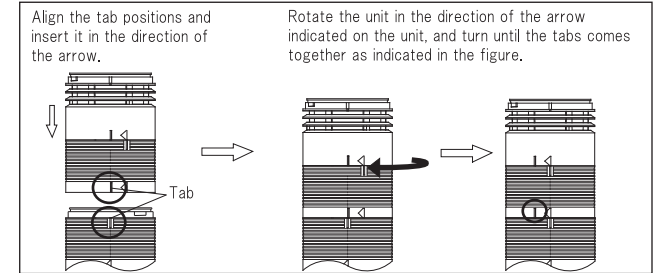
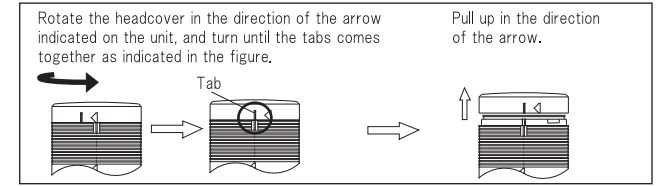

## 5 Unit Removal and Setup Method

### Warning

- Be sure the power is disconnected before working on the product. Failure to comply may result in damage of the internal circuitry and the danger of electric shock due to short-circuiting.

### 5-1. Unit Removal Method

[Procedure 1]

With the power disconnected, rotate in the direction of the arrow indicated on the unit, and turn until the tabs comes together as indicated in the figure.

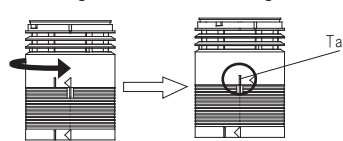

[Procedure 2]

The buzzer unit can be removed from the control base unit.

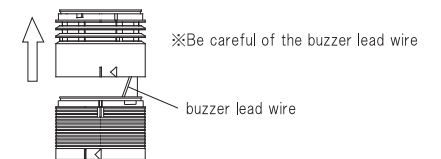

### 5-2. Buzzer Pattern Setup [Patterns 1-4]

A buzzer pattern can be selected.  
Select one from patterns 1-4.

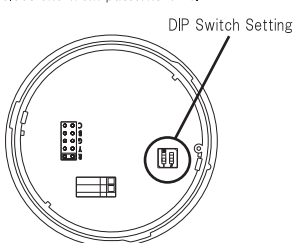

Pattern No.	DIP Switch	Sound Pattern
① ※	1-ON 2-OFF	3900Hz
②	1-ON 2-OFF	2700Hz
③	1-OFF 2-ON	2500Hz
④	1-ON 2-ON	2000Hz

※Factory Setting

### 5-3.Signal-wire Setup [R-Y-G-B-C Pin]

Select the signal line to be used for the buzzer. Select one from the R,Y,G,B,C pins and insert the socket into one of the pins. Also, the pattern sound changes when in combination of a signal line and LED unit.

#### ●Operating the LED Unit and buzzer together

The buzzer sound is set to operate with the LED unit lighting. Please insert the socket into the pin for the color which is going to be used for an LED unit, among the R, Y, G, B, C pins.

#### Setup Example

**Application for LED Red, Orange, Green, Blue (4 tiers) + This Unit**  
Select the "R" terminal when using the red LED unit with the buzzer when lighting the LED unit. On terminal No.1 of the base unit, the buzzer sounds with the red LED unit signal line.

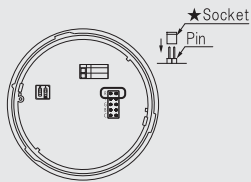

【Signal-wire Setup】	
Socket Position	Base Unit Terminal No. (Terminal Color)
R	No.1(Red)
Y	No.2(Amber)
G	No.3(Green)
B	No.4(Blue)
C※	No.5(White)

※Factory Setting

#### ●Operating the LED Unit and buzzer separately

The buzzer can be controlled separately from when the LED is lighting-up. Please insert the socket into the pin for the color which is not being used for an LED unit, among the R, Y, G, B, C pins. ※If all LED units of red, orange, green, blue and white are being used, this method cannot be used. Since the buzzer sounds with the LED units, either remove an LED unit or use the buzzer with it.

#### Setup Example

**Application for LED Red, Orange, Green (3 tiers) + This Unit**  
Use the signal lines, such as Blue or White that are not used, and select either B or C. If it is set to B, terminal No.4 (blue) of the base unit becomes the signal line only for the buzzer to sound.

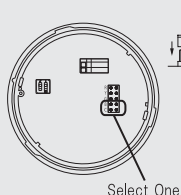

【Signal-wire Setup】	
Socket Position	Base Unit Terminal No. (Terminal Color)
R	No.1(Red)
Y	No.2(Amber)
G	No.3(Green)
B	No.4(Blue)
C※	No.5(White)

※Factory Setting



Please

- Be careful not to lose the socket.
- Insert the socket securely onto the pin. The buzzer may not sound if it is not fully inserted.
- Do not control an LED flash with the signal line when the buzzer is set with it. The buzzer is not sounding normal.
- Do not insert the socket into two or more pins simultaneously. All LED units light up in correspondence to the socket position.

### 5-4.Unit Mounting Instructions

#### [Procedure 1]

Align the Tab for the buzzer unit and insert.

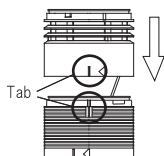

#### [Procedure 2]

Rotate in the direction of the arrow indicated on the unit, and turn until the Tabs comes together as indicated in the figure.

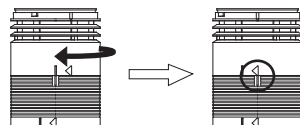

#### Caution

- Do not allow the buzzer lead-wire get caught or pinched between the units when fastening together.

### 5-5.Wiring

If wiring is not done on the base unit side yet, then wire the lead-wires first.

As indicated in "5-3.", wire the terminal No. in correspondence to the color of the buzzer socket position using the setup method.

※Refer to the LU7 base unit operation manual for details on the wiring process.

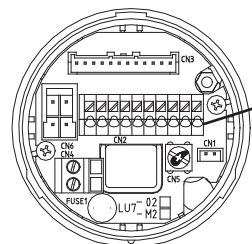

#### Setting Example 1

When the socket position is set as R for the signal line

Socket Color	R	Y	G	B	C
Terminal No.	1	2	3	4	5

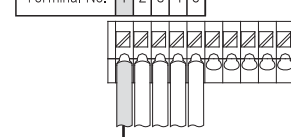

Terminal No.1. becomes the buzzer signal line.

※Recommended lead wire types and gauges :  
UL1007 AWG22 - 16  
UL1430 AWG 22 - 16

※Lead wire strip lengths : 9 mm

※Temperature rating should be above 75°C, and the conductor material should be of copper wire.

#### Caution

- Strip only the necessary amount of lead wire. Too short or too long may cause a poor connection, electric shock or short-circuit.
- When wiring, be careful not to short-circuit any uninsulated wires, etc.

## 6 Troubleshooting

If a problem occurs, check the following table to remedy the problem before calling for service.

No.	Problem	Where to Check
1	No buzzer sound coming out.	Check whether the socket for the Control PCB has fallen off. Check that the socket position and wiring for the Control PCB are correct.
2	The buzzer sound cuts off.	Check that the LED unit is not blinking with the signal line set to work with the buzzer.
3	The buzzer sound is too low.	Check whether any foreign substances are blocking the buzzer.

## 7 Specifications

Model	LU7-LB	
Rated Voltage	24V DC (No Polarity)	
Operating Voltage Range	Rated Voltage $\pm 10\%$	
Rated Current Consumption	Max. 150mA	
Operating Ambient Temperature	- 20°C to + 60°C	
Operating Ambient Humidity	Less than 90 % (No condensation)	
Storage Ambient Temperature	- 35°C to + 65°C	
Storage Ambient Humidity	Less than 90 % (No condensation)	
Mounting Location	Indoors	
Mounting Direction	Upright	
Mounting Method	Limited to the LU7 maximum tiers for mounting (Not including LU7-02S□-USB)	
Protection Rating	IP40 (IEC 60529)	
Environmental Condition	Mounted in the upright position	
Vibration Resistance IEC 60068-2-6	LED Unit	0 ~ 2Tiers 10m/s <sup>2</sup> , 10 ~ 150Hz
	3 ~ 5Tiers	5m/s <sup>2</sup> , 10 ~ 150Hz
	※Direct Mounting , Wall Mount Bracket (SZ-018□ only)	
Buzzer Sound Pattern	5-2.Buzzer Pattern Setup Pg.2	
Sound Pressure Level	100 $\pm$ 5dB	
Environmental Condition	All direction from the center at 1m, Buzzer Pattern ①	
Mass (Tolerance $\pm 10\%$ )	140 g	
Conformity Standards	FCC Part15 SubpartB Class A EMC Directive (EN 61000-6-4, EN 61000-6-2) RoHS Directive (EN 50581)	
Remarks	Conforms to the CE requirements	

[Outer Dimension Drawing]

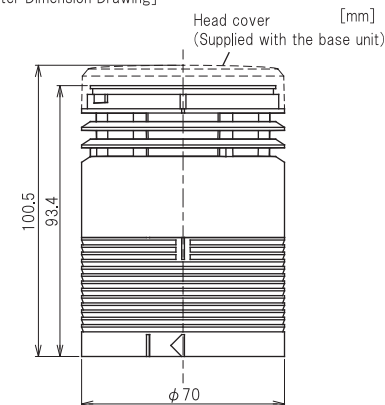

[ Fig. Directivity ]

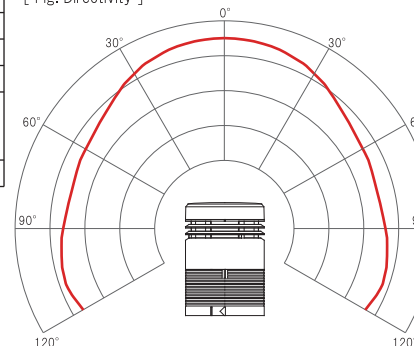

#### [Note]

- This product must not be used in residential areas.
- This equipment has been tested and found to comply with the limits for a Class A digital device, pursuant to Part 15 of the FCC Rules. These limits are designed to provide reasonable protection against harmful interference when the equipment is operated in a commercial environment.
- Dimensions, specifications and structure are subject to change for improvement without notice.
- PATLITE is a trademark or registered trademark of the PATLITE Corporation in JAPAN and/or other countries.

## PATLITE Corporation

G2G

**PATLITE Corporation** ※Head office ■ <http://www.patlite.com/>  
4-1-3, Kyutaromachi, Chuo-ku, Osaka 541-0056 Japan

**PATLITE (U.S.A.) Corporation** ■ <http://www.patlite.com/>

**PATLITE Europe GmbH** ※Germany ■ <http://www.patlite.eu/>

**PATLITE (SINGAPORE) PTE LTD** ■ <http://www.patlite.com/>

**PATLITE (CHINA) Corporation** ■ <http://www.patlite.cn/>

**PATLITE KOREA CO., LTD.** ■ <http://www.patlite.co.kr/>

**PATLITE TAIWAN CO., LTD.** ■ <http://www.patlite.tw/>

**PATLITE (THAILAND) CO., LTD.** ■ <http://www.patlite.co.th/>

C95100137 D  
'16.08.AUTO