

## SPECIFICATIONS

Model	RHE-12UL		RHE-24UL	
Rated voltage	12V DC		24V DC	
Operating voltage	10.8V ~ 13.2V DC		21.6 ~ 26.4V DC	
Current consumption	0.25A or less		0.16A or less	
Power consumption	3.0W or less		4.0W or less	
Flashing rate	120 ±25 Flashes Per Minute			
Operating ambient temperature (Relative humidity)	- 10℃ ~ + 50℃ (Less than 90%,non condensing)			
Mounting location	Indoor only			
Mounting direction	Upright, Updown & Sideways			
Protection rating	IP23 (With option rubber gasket(SZ-200A) : IP55.)			
Vibration resistance	Acceleration 70m/s <sup>2</sup> Frequency range 33Hz			
Insulation resistance	More than 1MΩ at 500VDC between the terminals and the chassis			
Withstand voltage	500VAC applied for 1min between terminals and chassis without breaking insulation			
Luminous intensity	Red	Amber	Green	Blue
	3000cd or more	3000cd or more	2500cd or more	2000cd or more
Mass	0.4 kg (± 10%)			
Remarks	<div>▪ This product confirms to the CE requirements and CE Marking is indicated.</div> <div>▪ This product complies with the RoHS Directive.(DIRECTIVE 2002/95/EC)</div> <div>▪ This product recognized as UL standard.</div> <div>(Standard No.UL1638, UL464, File No.S24210)</div>			
No.RHE-24UL-PDFC-EN-1_2				

Model No. configuration

RHE-□□UL-□

Rated voltage  
12:12VDC  
24:24VDC

Color  
R:Red  
Y:Amber  
G:Green  
B:Blue

Terminal view

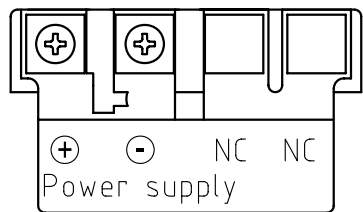

Wiring example

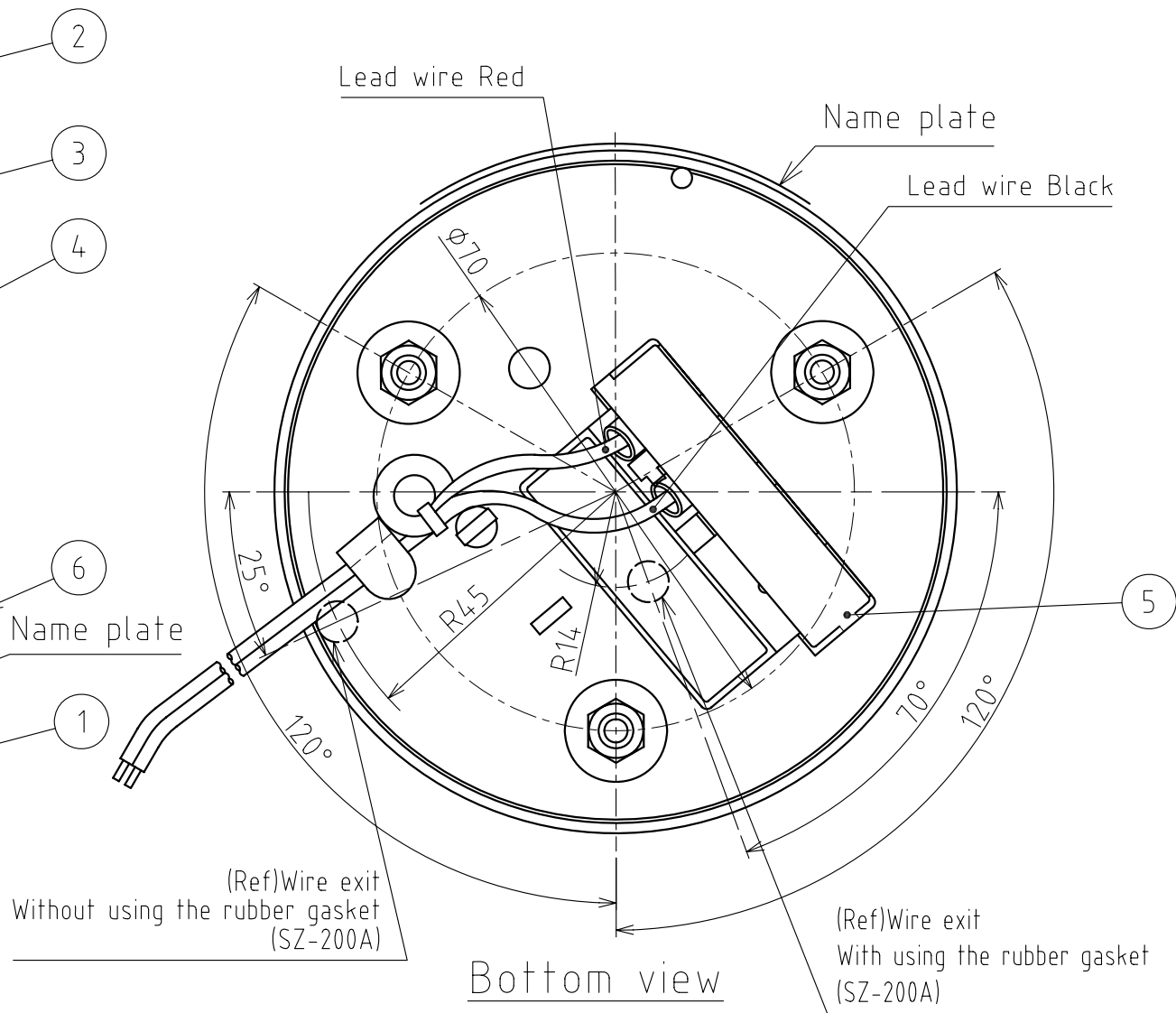
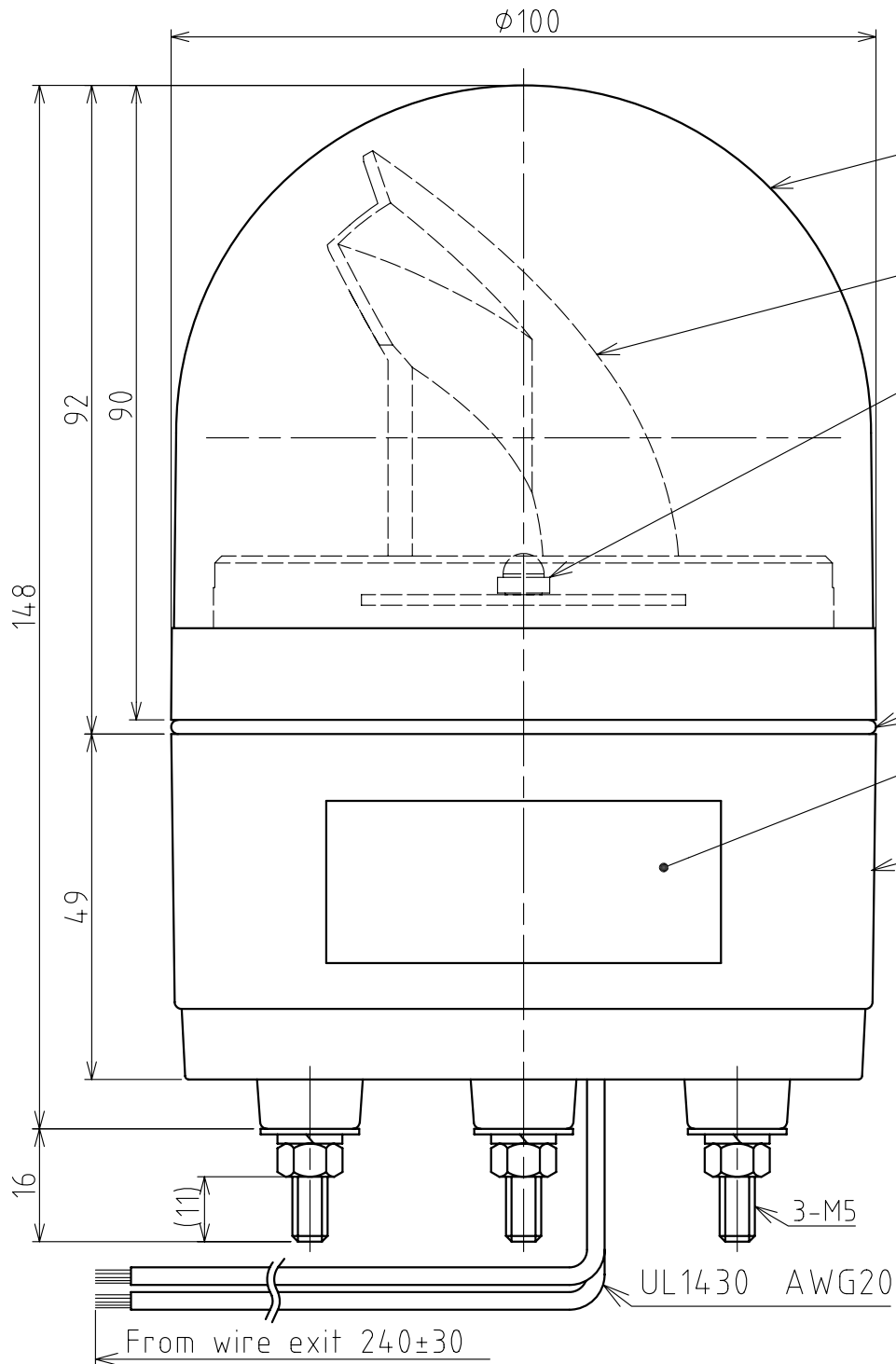
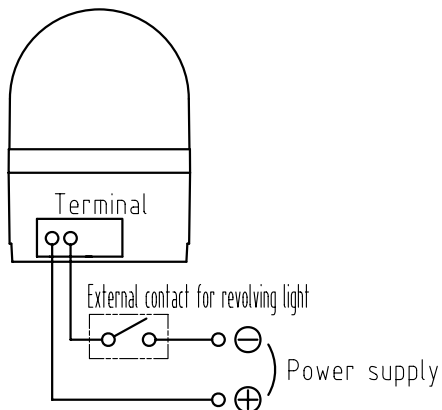

Notes

1. Use "Class 2 Circuit" for the power supply source
2. When using the product with the optional rubber gasket SZ-200A, install the product on the flat surface to keep the waterproof IP55.

6	O-ring	-	1	Si	
5	Terminal cover	-	1	PC(Clear)	
4	LED P.C.B. assembly	-	1		
3	Reflector	-	1	PC/Aluminum coating	
2	Dome	-	1	PC(Red,Amber,Green,Blue)	
1	Body	-	1	ABS(Light gray)	
番号 No.	部品名 Part Name	品目コード Part No.	数量 Qty.	材料 & 寸法 & 処理 Material & Size & Finish	記事 Remarks

RHE-12/24UL Dimensions

株式会社 パトライト  
PATLITE Corporation

RHE-24UL-PDFC-EN-2\_2

生産終了  
Production end