

New

LR6 USB SIGNAL TOWER

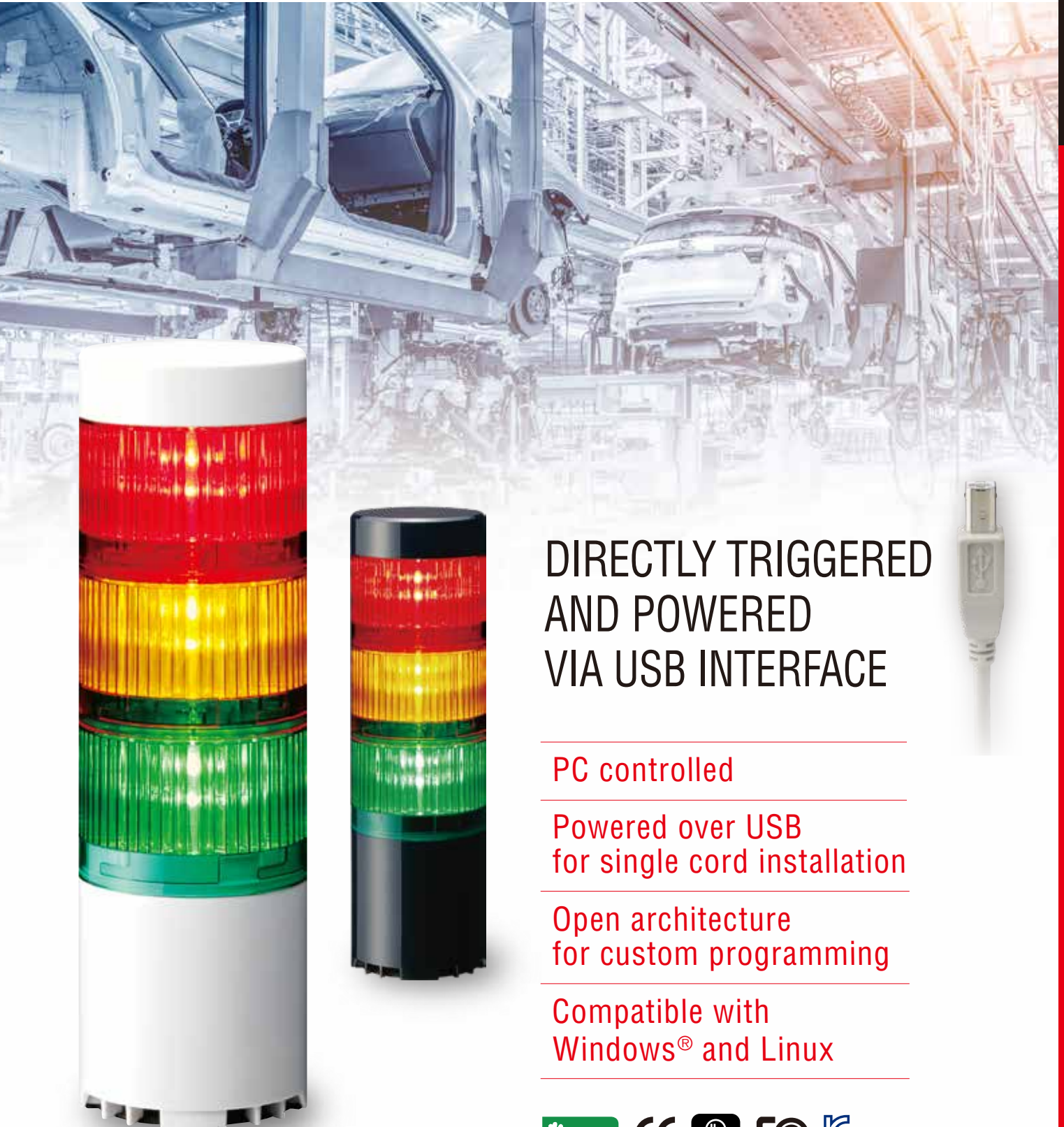

DIRECTLY TRIGGERED
AND POWERED
VIA USB INTERFACE

PC controlled

Powered over USB
for single cord installation

Open architecture
for custom programming

Compatible with
Windows® and Linux



The optimal solution unique to the FA field is a USB connection

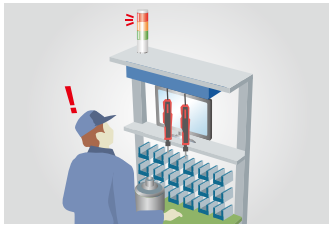

Production Line
Error notification without a PLC.



Interface with equipment
Display the status condition of PC controlled units, such as a printer.

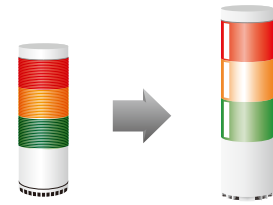

Compatible with PATLITE's LU7-USB Model
PATLITE's LU7-USB software is also compatible.
No need to make program corrections.

Uses a software library

- The use of a software library (downloadable from our website), makes controlling it simple.
- Download a demo application and sample code from our website.

No need for exclusive driver installations

- Installing an exclusive driver is unnecessary because it is supported in the HID device class.

Also supports wall mounting, pole mounting

- A variety of attachment options are available.

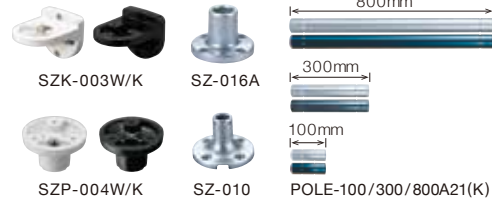

example



* For details of optional items etc., come visit our website.

Specifications

Model	LR6-3USB□-RYG	LR6-USB□
Rated Voltage	5V DC (USB bus power)	
Operating Voltage Range	Rated voltage ±5% *Compliant with USB2.0 standard	
Rated Current Consumption	500mA (max)	
Ambient Operating Temperature	-20°C to +50°C	
Ambient Operating Humidity	90% RH or less, no condensation	
Mounting location / direction	Indoors / Upright	
Protection Rating	IP65 (IEC 60529), NEMA TYPE 4X,13 * Except when using pole bracket or wall bracket.	
Mass (Tolerance: ±10%)	320g	140g
LED unit control	Light on, pattern on (4 types)	
Buzzer	Operation: Sound on, sound pattern (4 types)	
	Frequency: 13 types	
	Sound pressure: Typ.80dB (1m from the front of the buzzer aperture / at 2349.3 Hz), Sound reduction (Buzzer switch: Low): approximately -10dB	
Communication method	USB2.0 Full Speed	
Software library (DLL) Supported OS	Windows®7, Windows®8 (excluding Windows®8 RT), Windows®8.1 (excluding Windows®8.1RT), Windows®10	

Model Number Configuration

LR6-□USB□-RYG

Signal Tower Tiers	Body Color	LED Unit Color
Blank : Base Unit 3 : 3 Tiers*	W : Off-white K : Black	Blank : Body Unit RYG : Red, Amber, Green (From top to bottom)

*Pre-assembled model is not available in North America.

Supported LED Unit



- The maximum number of LED unit attachments for LR6-E-□ and LR6-E-□Z, is five in total.
- No units other than the supported LED units are compatible.
- Two or more LED units of the same color for LR6-E-□ and LR6-E-□Z are not connectable.
- No other units are connectable for the LR6-E-MZ.
- There are two kind of patterns when lighting the LR6-E-MZ.

Outer Dimensional Drawing

[mm]

■ LR6-3USB□-RYG

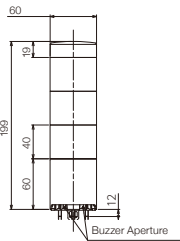

■ LR6-USB□

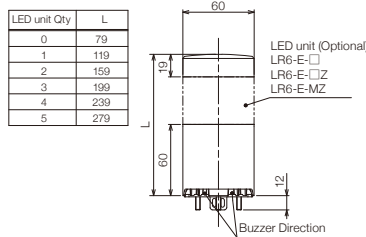

■ Mounting Dimensional Drawing

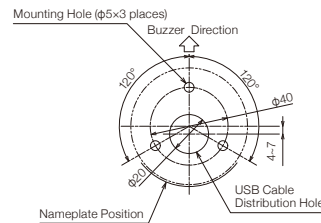

■ Applicable USB Cable Dimensions

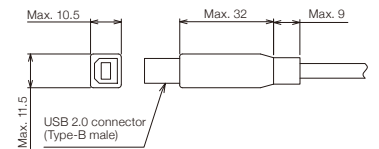

PATLITE Corporation

4-1-3, Kyutaromachi, Chuo-ku, Osaka 541-0056 Japan
International Sales Division
TEL:+81-6-7711-8953 FAX:+81-6-7711-8961 E-mail:overseas@patlite.co.jp

PATLITE (U.S.A.) Corporation

20130 S. Western Ave. Torrance, CA 90501, U.S.A.
TEL:+1-310-328-3222 FAX:+1-310-328-2676 E-mail:sales@patlite.com

PATLITE (SINGAPORE) PTE LTD

No.2 Leng Kee Road, #05-01 Thye Hong Centre, Singapore 159086
TEL:+65-6226-1111 FAX:+65-6324-1411 E-mail:sales@patlite.com.sg

PATLITE (CHINA) Corporation

Room 1102-1103, No.55, Lane 777, Guangzhong Road (West), Zhabei District, Shanghai, China 200072
TEL:+86-21-6630-8969 FAX:+86-21-6630-8938 E-mail:sales@patlite.cn

PATLITE Europe GmbH

Am Soeldnermoos 8, D-85399 Hallbergmoos, Germany
TEL:+49-811-9981-9770-0 FAX:+49-811-9981-9770-90 E-mail:info@patlite.eu

PATLITE KOREA CO., LTD.

A-2603, Daesung D-POLIS, 606, Seobusaet-gil, Geumcheon-gu, Seoul, 08504, Korea
TEL:+82-2-523-6636 FAX:+82-2-861-9919 E-mail:sales@patlite.co.kr

PATLITE TAIWAN CO., LTD.

2F-1, No.215, Sec. 2, Chengde Rd., Datong Dist., Taipei City 10364, Taiwan (R.O.C.)
TEL:+886-2-2555-1611 FAX:+886-2-2555-1621 E-mail:info@patlite.tw

PATLITE (THAILAND) CO., LTD.

Olympia Thai Tower, 15th Floor 444 Ratchadapisek Road Samsenok, Huay Kwang Bangkok 10310, Thailand
TEL:+66-2-541-5431 FAX:+66-2-541-5429 E-mail:sales_150716@patlite.co.th

www.patlite.com

●PATLITE, the PATLITE logo are either registered trademarks or trademarks of PATLITE Corporation in JAPAN and/or other countries.

CAUTION

To ensure correct use of these products, read the "Instruction Manual" prior to use. Failure to follow all safeguards can result in fire, electric shock, or other accidents. Specifications are subject to change without notice.

O-AH02B EN 1811 B